



Construction characteristic

| | |
|-----------------|--|
| End covers | nylon 66 reinforced with glass fibres |
| Barrel | nylon 66 reinforced with glass fibres |
| Piston rod | C43 Chromed (non magnetic piston version) stainless steel (magnetic piston version) |
| Piston | aluminium |
| Seal | NBR oil-resistant rubber seal |
| Piston rod seal | PUR |
| Mounting | steel painted / stainless steel AISI 304 |
| Forks | zinc plated steel / stainless steel AISI 304 |

Technical characteristics

| | |
|--------------------------|--|
| Fluid | filtered air and preferably lubricated |
| Maximum working pressure | 8 bar |
| Working temperature | -5°C - +50°C |

Please follow the suggestions below to ensure a long life for these cylinders:

- use clean and lubricated air
- correct alignment during assembly with regard to the applied load so as to avoid radial components or bending the rod.
- avoid high speeds together with long strokes and heavy loads: this would produce kinetic energy which the cylinder cannot absorb, especially if used as a limit stop (in this case use mechanical stop device)
- evaluate the environmental characteristics of cylinder used (high temperature, hard atmosphere, dust, humidity etc.)

Please note: air must be dried for applications with lower temperature.

Use hydraulic oils H class (ISO Vg32) for correct continued lubrication.

Our Technical Department will be glad to help.

Standard strokes

Ø 12

15 - 25 - 50 - 75 - 80 - 100 - 125 - 150 - 160 - 200 mm

Ø 16

15 - 25 - 50 - 75 - 80 - 100 - 125 - 150 - 160 - 200 - 250 mm

Ø 20 - Ø 25

15 - 25 - 50 - 75 - 80 - 100 - 125 - 150 - 160 - 200 - 250 - 300 mm

Maximum tightening torque for fittings

| Bore | Thread | Maximum torque (Nm) |
|------|--------|---------------------|
| Ø 12 | M5 | 1 |
| Ø 16 | M5 | 1 |
| Ø 20 | G 1/8" | 4 |
| Ø 25 | G 1/8" | 4 |

| | Bore | Ø12 | Ø16 | Ø20 | Ø25 |
|------------|------------|----------|--------|---------|---------|
| WEIGHT gr. | stroke 0 | 50 gr. | 65 gr. | 120 gr. | 160 gr. |
| | every 10mm | 3,75 gr. | 4 gr. | 6,5 gr. | 9 gr. |

| | Bore | Ø12 | Ø16 | Ø20 | Ø25 |
|------------|------------|--------|---------|---------|---------|
| WEIGHT gr. | stroke 0 | 60 gr. | 75 gr. | 180 gr. | 200 gr. |
| | every 10mm | 7 gr. | 8,5 gr. | 10 gr. | 20 gr. |

Basic version

| Ordering code | Description |
|------------------------|-------------------------------|
| 1230.Ø.stroke | Basic version |
| 1230.Ø.stroke.M | Basic version magnetic piston |

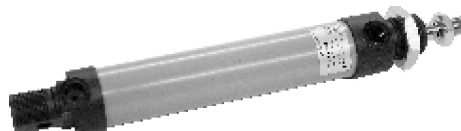

Standard version, fully complying with ISO standards. Can use all available mountings.

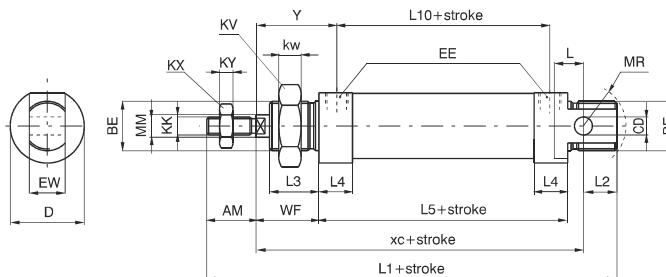

Without rear eye version

| Ordering code | Description |
|------------------------|--|
| 1231.Ø.stroke | Without rear eye version |
| 1231.Ø.stroke.M | Without rear eye version magnetic piston |



This version derived from standard version 1230 and not included in ISO standard. Not having a rear eye it is shorter. The inlet connection is lateral on the rear cover (like on the front cover).

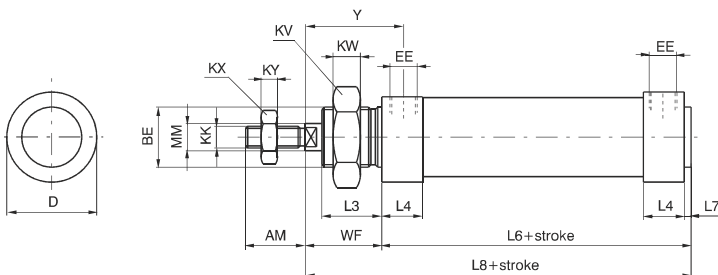

4

Push/Pull rod version

| Ordering code | Description |
|------------------------|---------------------------------------|
| 1232.Ø.stroke | Push/Pull rod version |
| 1232.Ø.stroke.M | Push/Pull rod version magnetic piston |



Through rod model, dimensions as for the 1230 (except the rod).

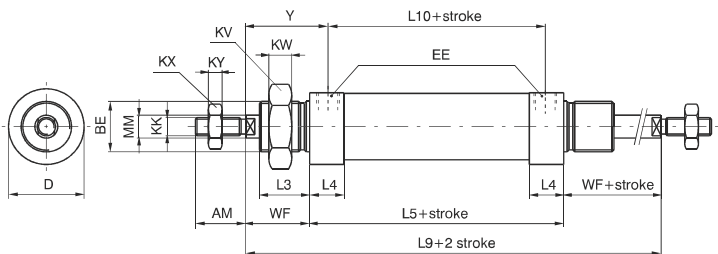

Table of dimensions

| Bore | AM (-0,2) | BE | CD (H9) | D | EE | EW (d13) | KK (6g) | KV | KW | KX | KY | L | L1 (±1) | L2 | L3 | L4 | L5 (±1) | L6 | L7 | L8 (±1,2) | L9 (±1) | L10 (±1) | MM (f7) | WF (±1,2) | XC (±1) | Y (±1) |
|------|-----------|---------|---------|------|-------|----------|----------|----|----|----|----|----|---------|----|----|------|---------|------|-----|-----------|---------|----------|---------|-----------|---------|--------|
| 12 | 16 | M16X1,5 | 6 | 19 | M5 | 12 | M6X1 | 22 | 6 | 10 | 4 | 9 | 105 | 14 | 17 | 13,5 | 50 | 52 | 2 | 74 | 94 | 41 | 6 | 22 | 75 | 26,5 |
| 16 | 16 | M16X1,5 | 6 | 23 | M5 | 12 | M6X1 | 22 | 6 | 10 | 4 | 9 | 111 | 13 | 17 | 14,5 | 56 | 58 | 2 | 80 | 100 | 45 | 6 | 22 | 82 | 27,5 |
| 20 | 20 | M22X1,5 | 8 | 28,5 | G1/8" | 16 | M8X1,25 | 30 | 7 | 13 | 5 | 12 | 130 | 15 | 18 | 20,5 | 68 | 70,5 | 2,5 | 94,5 | 116 | 52 | 8 | 24 | 95 | 32 |
| 25 | 22 | M22X1,5 | 8 | 31,5 | G1/8" | 16 | M10X1,25 | 30 | 7 | 17 | 6 | 14 | 140 | 14 | 22 | 20 | 68 | 70,5 | 2,5 | 98,5 | 124 | 52 | 10 | 28 | 104 | 36 |